

SPECIFICATION SHEET

Essence Fire - (Fire Ribbon®)

Page 1 of 2

Index Number : 56, Rev-7 [1-6-2010]

MATERIAL OPTIONS:

Supplied as a suite with Burner Enclosure and Fascia.

Burner: for NG or LPG

Enclosure: Black Steel with Brushed Stainless Shelves [NG or LPG]

Fascia Options: Black steel, Brushed Stainless [NG or LPG]

CE APPROVAL:

Currently CE tested, approved and available for the following countries:

NG-I2H-G20-20mBar

UK, EIRE, AUSTRIA, CZECH REPUBLIC, DENMARK, ESTONIA, FINLAND, GREECE, ITALY, LITHUANIA, LATVIA, NORWAY, PORTUGAL, ROMANIA, SLOVENIA, SLOVAKIA, SPAIN, SWEDEN, SWITZERLAND, TURKEY.

NG-I2E-G20-20mBar

GERMANY, LUXEMBOURG, POLAND, ROMANIA

NG-I2E⁺-G20/G25-20/25mBar

FRANCE, BELGIUM

NG-I2L-G25-25mBar

NETHERLANDS

LPG-I3P(37)-G31-37mBar

UK, EIRE, BELGIUM, SWITZERLAND, CZECH REPUBLIC, FRANCE, GREECE, ITALY, PORTUGAL, SLOVENIA, SLOVAKIA, SPAIN, TURKEY

LPG-I3+G30/G31 - 28-30/37 mBar

UK, EIRE, BELGIUM, SWITZERLAND, CYPRUS, CZECH REPUBLIC, FRANCE, GREECE, ITALY, PORTUGAL, SLOVENIA, SLOVAKIA, SPAIN

LPG-I3B/P - G30/G31 - 30mBar

UK, BELGIUM, CYPRUS, DENMARK, ESTONIA, FINLAND, FRANCE, GREECE, HUNGARY, LITHUANIA, NETHERLANDS, NORWAY, ROMANIA, SWEDEN, SLOVENIA, SLOVAKIA, SPAIN, TURKEY

DIMENSIONS:

Overall dimensions of fascia/surround:

HEIGHT: 405mm x WIDTH: 658mm x DEPTH: 10mm

Dimensions of standard enclosure:

HEIGHT: 265mm x WIDTH: 518mm x DEPTH: 335mm

Dimensions of required construction opening:

Without Gather: HEIGHT: 470mm x WIDTH: 550mm x DEPTH: 370mm

The gather can be fitted into the chimney void, the enclosure slid in then the gather joined back up to the fire. This allows for a smaller construction opening.

ESSENCE FIRE POWER RATING:

High and low flame settings (gas only):

Heat input high: NG - 6.4KW

LPG input high: LPG - 4.9KW

Heat input low: NG - 3.8KW

LPG input low: LPG - 3.8KW

OTHER TECHNICAL INFORMATION:

- Gas Types** : Fire available for Natural Gas or LPG/Propane. Specify when ordering.
- Control System** : Battery Operated Remote Control with IR Magic Eye and Wall Switch. Full Sequence - ON/OFF & UP/DOWN.
- Chimney System** : Class 2 or Minimum 2 meter x 127mm Flue Liner from above top of gather height.
- Safety Devices** : ODS (Oxygen Depletion System) and FFD (Flame Failure Device).
- For air brick requirements please see air brick chart below in relation to high input settings.
- Approximate running costs per hour on low (subject to your gas supplier tariff): NG - 10.05p, LPG 18.00p.
- When installing this into an existing chimney with a flue liner the enclosure & gather must be sealed to the existing chimney to ensure that air cannot flow behind the enclosure. Failure to do this will result in serious damage to the burner unit and enclosure.
- It is recommended to buy the standard gather with the fire to ensure correct installation and to stop debris falling into the enclosure.
- For the builders opening please 50mm gap around the sides and back of the unit for adjustments.

Spirit Fires Limited reserve the right to amend and improve any of the specification sheets without prior notice.

All fires are living flames. Sooting can occur as a natural bi-product of a living flame and cannot be controlled or eliminated. Weathering and sooting of the enclosures is a natural and normal occurrence. This, understandably is more obvious on light coloured materials such as white stone and white powder coated steel.

Cast bronze and cast iron are hand sand cast and polished. Pitting and air holes are normal and a part of the unique quality of such a piece.

NOTE - The low-rate on the burner unit has a running noise level due to the nature of the gas flow rate through the valve. This is normal for the size of this fire.



AIRBRICK CHART

Input Energy:

0-7KW	No Airbrick Required
8-9KW	11cm ² free air
10-15	36cm ² free air
16-18KW	50cm ² free air

KEY

NG - NATURAL GAS
SF - SOLID FUEL
LPG - LIQUID PETROLEUM GAS
ALL DIMENSIONS WITHIN +/- 2mm

Spirit Fires Ltd, 4 Beaumont Square Durham Way South Aycliffe Industrial Park
Newton Aycliffe County Durham DL5 6SW
Tel: +44 (0) 1325 327 221 Fax: +(0)1325 327 292
Email info@cvo.co.uk

www.spiritfires.co.uk

Spirit Fires Incorporates the full CVO Fire range of Fires. For more details contact above or visit www.cvo.co.uk

CVO FIRE 

SPECIFICATION SHEET
Essence Fire - (Fire Ribbon®)
 Page 2 of 2
 Index Number : 56, Rev-7 [1-6-2010]

NOTE: The dimensions on this product are for a metal enclosure

Top view

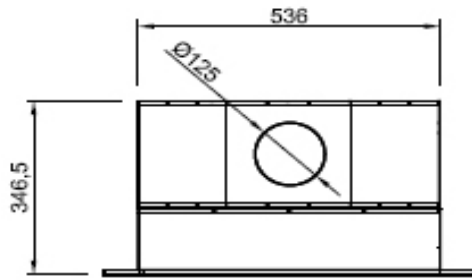

Perspective view

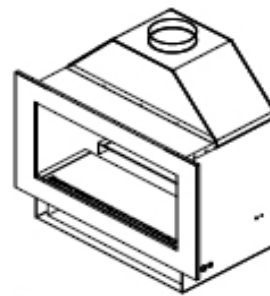

Front view

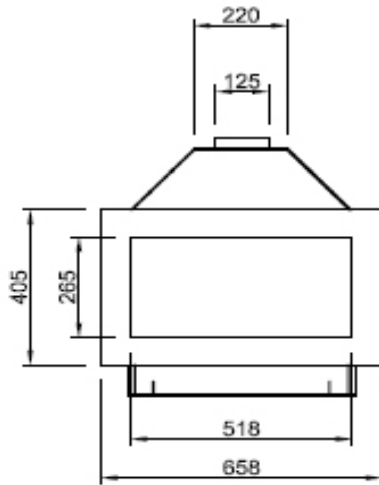

Side view

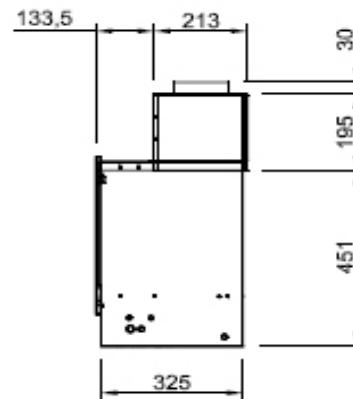

For the builders opening please allow room for adjustments, gas and electric supply.

NOTE - Allow 50mm gap around the sides and back of the unit

Gathers are optional depending upon installation requirements. If the standard gather is not to be used, the fire must be connected to the inglenook in accordance with CORGI and local regulations. The gather shown is for dimensional purposes only. The gather can be supplied as an optional extra. Please specify when placing your order.

Spirit Fires Limited reserve the right to amend and improve any of the specification sheets without prior notice.

All fires are living flames. Sooting can occur as a natural bi-product of a living flame and cannot be controlled or eliminated. Weathering and sooting of the enclosures is a natural and normal occurrence. This, understandably is more obvious on light coloured materials such as white stone and white powder coated steel.

Cast bronze and cast iron are hand sand cast and polished. Pitting and air holes are normal and a part of the unique quality of such a piece.

NOTE - The low-rate on the burner unit has a running noise level due to the nature of the gas flow rate through the valve. This is normal for the size of this fire.



AIRBRICK CHART

Input Energy:	
0-7KW	No Airbrick Required
8-9KW	11cm ² free air
10-15	36cm ² free air
16-18KW	50cm ² free air

KEY

NG - NATURAL GAS
 SF - SOLID FUEL
 LPG - LIQUID PETROLEUM GAS
 ALL DIMENSIONS WITHIN +/- 2mm

Spirit Fires Ltd, 4 Beaumont Square Durham Way South Aycliffe Industrial Park
 Newton Aycliffe County Durham DL5 6SW
 Tel: +44 (0) 1325 327 221 Fax: +(0)1325 327 292
 Email info@cvo.co.uk

www.spiritfires.co.uk

Spirit Fires Incorporates the full CVO Fire range of Fires. For more details contact above or visit www.cvo.co.uk